

# FRAME AND BUMPERS

## TABLE OF CONTENTS

	page		page
BUMPERS .....	1	FRAME .....	5

## BUMPERS

### TABLE OF CONTENTS

	page		page
<b>DESCRIPTION AND OPERATION</b>		FRONT ABSORBER.....	2
BUMPERS.....	1	REAR FASCIA .....	2
<b>REMOVAL AND INSTALLATION</b>		REAR ABSORBER.....	4
FRONT FASCIA .....	1		

### DESCRIPTION AND OPERATION

#### BUMPERS

##### DESCRIPTION

The bumpers on the Jeep Grand Cherokee are made up of an absorber attached to the unibody frame rails and covered by the front and rear fascia. Some Grand Cherokee models also have a tow hook support bracket fastened to the front unibody rail crossmember.

##### OPERATION

The bumpers absorb minor impacts and protect exterior sheetmetal components.

### REMOVAL AND INSTALLATION

#### FRONT FASCIA

##### REMOVAL

- (1) Raise and support vehicle.
- (2) Turn front wheels to access rivets and remove plastic rivets attaching fascia to wheel liner.
- (3) Remove bolts attaching fascia to fender (Fig. 1).

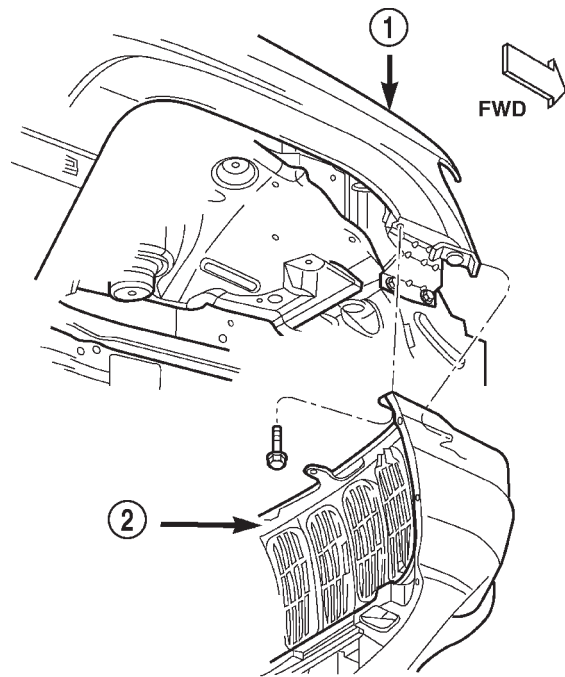

80b46af0

**Fig. 1 Front Fascia**

- 1 - BODY
- 2 - FASCIA

## REMOVAL AND INSTALLATION (Continued)

- (4) Remove plastic push pin fasteners attaching front fascia to lower radiator crossmember splash shield (Fig. 2).
- (5) Disengage fog lamp connectors, if equipped.
- (6) Remove screws attaching fascia/grille to upper radiator crossmember (Fig. 3).
- (7) Slide fascia forward to separate from vehicle.

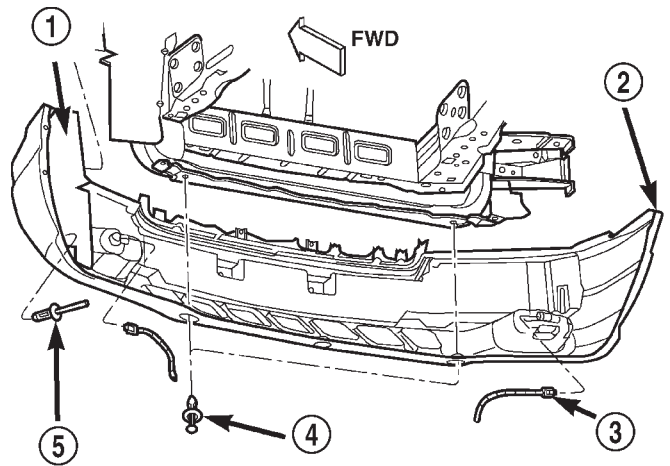

80b46aec

**Fig. 2 Front Fascia**

- 1 - WHEEL LINER
- 2 - FASCIA
- 3 - FOG LAMP CONNECTOR
- 4 - PLASTIC PUSH PIN
- 5 - PLASTIC RIVET

## INSTALLATION

- (1) Slide fascia onto vehicle engaging fascia with tabs on bottom of front fenders.
- (2) Install screws attaching fascia/grille to upper radiator crossmember.
- (3) Install bolts attaching fascia to fender.
- (4) Engage fog lamp connectors, if equipped.
- (5) Install plastic rivets attaching fascia to wheel liner.
- (6) Install plastic push pin fasteners attaching front fascia to lower radiator crossmember splash shield.
- (7) Remove supports and lower vehicle.

## FRONT ABSORBER

## REMOVAL

- (1) Remove front fascia.
- (2) Remove the retainer attaching the absorber to the fascia.
- (3) Separate the absorber from the fascia.

## INSTALLATION

- (1) Position the absorber on the fascia.
- (2) Install the retainer attaching the absorber to the fascia.
- (3) Install front fascia.

## REAR FASCIA

## REMOVAL

- (1) Raise and support vehicle.
- (2) Remove tires.
- (3) Remove plastic push pins attaching fascia to fuel tank skid plate.
- (4) Remove plastic rivets attaching fascia to wheel liner.
- (5) Remove nuts attaching upper edge of fascia to quarter panel and wheel liner (Fig. 4).
- (6) Remove plastic push pins attaching fascia to liftgate opening (Fig. 5).
- (7) Remove screws attaching fascia to liftgate opening.
- (8) Remove D pillar trim and scuff plate outboard screws.
- (9) Remove the rearward tie down screws and the aperture trim panel.
- (10) Carefully peel back the rubber body sealer patch to access the retainer clips.
- (11) Release the forward and rearward retainer clips on both sides of the fascia.
- (12) Grasp forward edges of fascia and pull outward to disengage retainers attaching fascia to quarter panel (Fig. 6).
- (13) Separate fascia from vehicle.

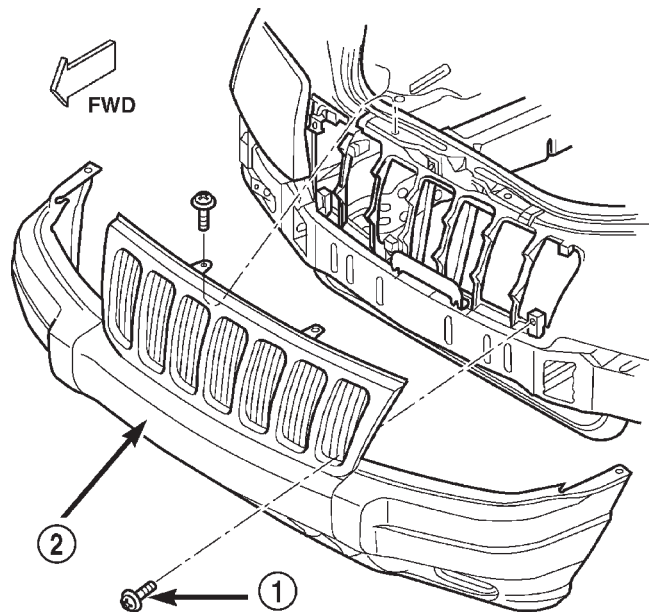

80b46aeb

**Fig. 3 Front Fascia**

- 1 - SCREW
- 2 - FASCIA

REMOVAL AND INSTALLATION (Continued)

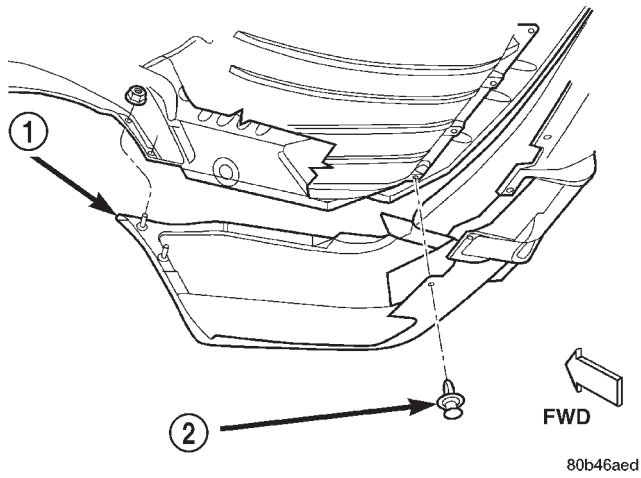

**Fig. 4 Rear Fascia Attachment**

- 1 - FASCIA
- 2 - PLASTIC PUSH PIN

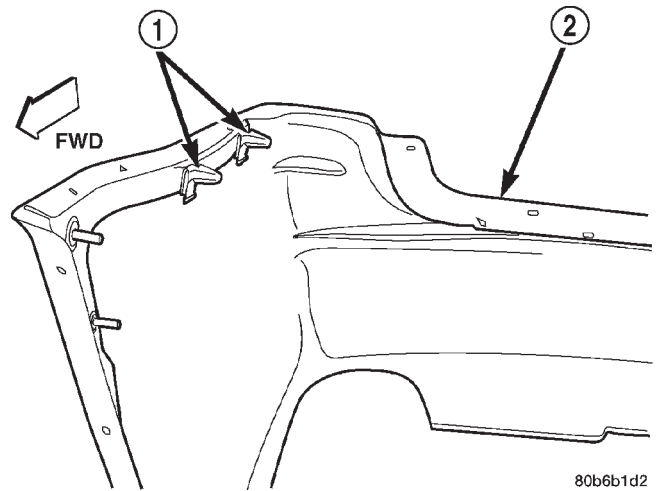

**Fig. 6 Rear Fascia Retainers**

- 1 - RETAINER
- 2 - FASCIA

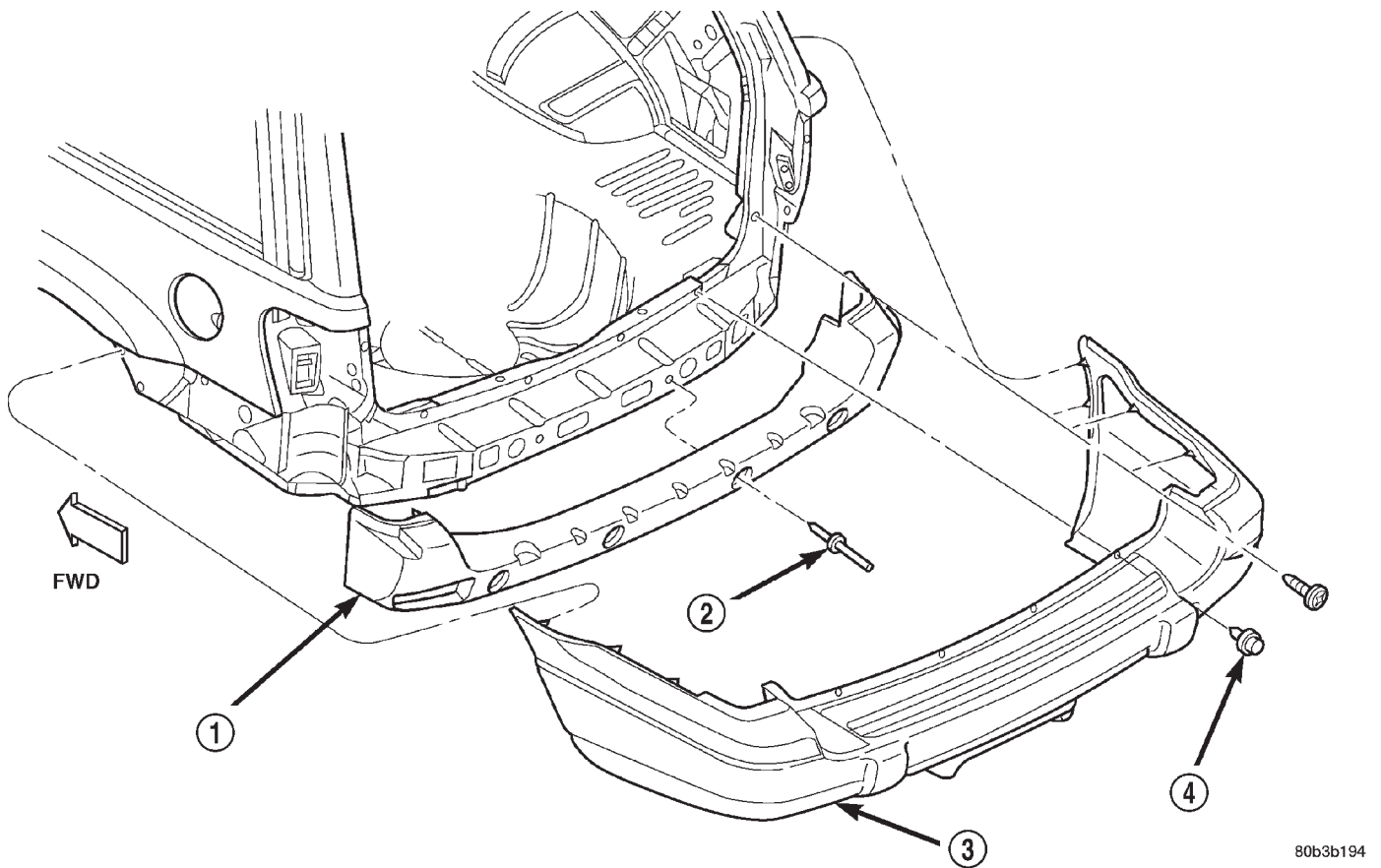

**Fig. 5 Rear Fascia**

- 1 - ABSORBER
- 2 - RIVET
- 3 - FASCIA
- 4 - PLASTIC PUSH PIN

## REMOVAL AND INSTALLATION (Continued)

**INSTALLATION**

(1) Position fascia on vehicle aligning retainers with slots in quarter panel (Fig. 7).

(2) Press forward edges of fascia inward to engage retainers.

(3) Install screws attaching fascia to liftgate opening.

(4) Install plastic push pins attaching fascia to liftgate opening.

(5) Install nuts attaching upper edge of fascia to quarter panel and wheel liner.

(6) Install plastic rivets attaching fascia to wheel liner.

(7) Install support lower vehicle.

(8) Install plastic push pins attaching fascia to fuel tank skid plate.

(9) Install the interior trim panels removed to access fascia retainers.

(10) Install tie down loop screws.

(11) Install tires.

**REAR ABSORBER****REMOVAL**

(1) Remove rear fascia.

(2) Remove rivets attaching absorber to rear cross-member (Fig. 5).

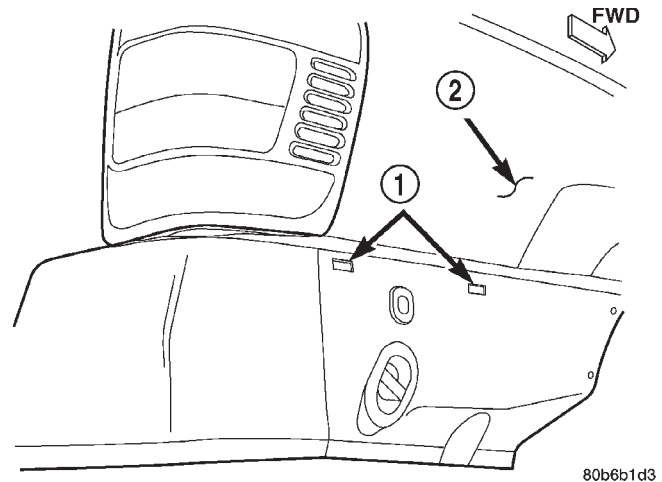

**Fig. 7 Fascia Attachment**

- 1 - SLOT  
2 - QUARTER PANEL

(3) Separate absorber from vehicle.

**INSTALLATION**

(1) Position absorber on vehicle.

(2) Install rivets attaching absorber to rear cross-member.

(3) Install rear fascia.

# FRAME

## TABLE OF CONTENTS

	page		page
<b>DESCRIPTION AND OPERATION</b>		<b>FUEL TANK SKID PLATE</b> .....	6
FRAME .....	5	<b>REAR TOW HOOK</b> .....	6
<b>REMOVAL AND INSTALLATION</b>		<b>TRAILER HITCH</b> .....	6
FRONT TOW HOOK .....	5	<b>SPECIFICATIONS</b>	
FRONT SKID PLATE .....	5	FRAME DIMENSIONS .....	7
TRANSFER CASE SKID PLATE .....	6	TORQUE SPECIFICATIONS .....	10

## DESCRIPTION AND OPERATION

### FRAME

#### DESCRIPTION

Jeep Grand Cherokee vehicles do not have a conventional frame. They are constructed as a unitized body and frame. Jeep unibodies are constructed from special high strength steel and coated metals. This process reduces weight and provides strength to withstand the forces applied against structural members. The structural members provide a unibody that has great structural strength.

## REMOVAL AND INSTALLATION

### FRONT TOW HOOK

#### REMOVAL

- (1) Remove bolts that attach tow hook bracket to the lower crossmember (Fig. 1).
- (2) Separate tow hook bracket from lower crossmember.

#### INSTALLATION

- (1) Position tow hook bracket at the lower crossmember.
- (2) Install bolts attaching tow hook bracket to crossmember. Tighten bolts to 54 N·m (40 ft. lbs.) torque.

### FRONT SKID PLATE

#### REMOVAL

- (1) Position a support under skid plate.
- (2) Remove bolts attaching skid plate to frame (Fig. 2).
- (3) Separate skid plate from frame.

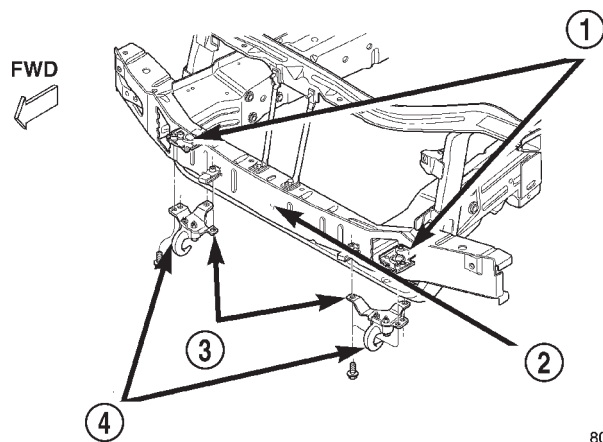

80b46aof

**Fig. 1 Front Tow Hook**

- 1 - TAPPING PLATE
- 2 - CROSSMEMBER
- 3 - BRACKET
- 4 - TOW HOOK

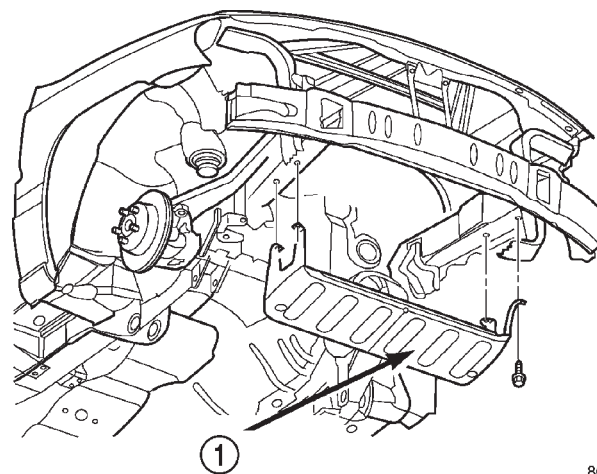

80b46a10

**Fig. 2 Front Skid Plate**

- 1 - SKID PLATE

## REMOVAL AND INSTALLATION (Continued)

## INSTALLATION

- (1) Position skid plate on a support.
  - (2) Raise it into position
  - (3) Install bolts attaching skid plate to frame.
- Tighten bolts to 54 N·m (40 ft. lbs.) torque.

## TRANSFER CASE SKID PLATE

## REMOVAL

- (1) Support skid plate.
- (2) Remove bolts that attach skid plate to transmission support crossmember and frame sill (Fig. 3).
- (3) Remove support and skid plate from vehicle.

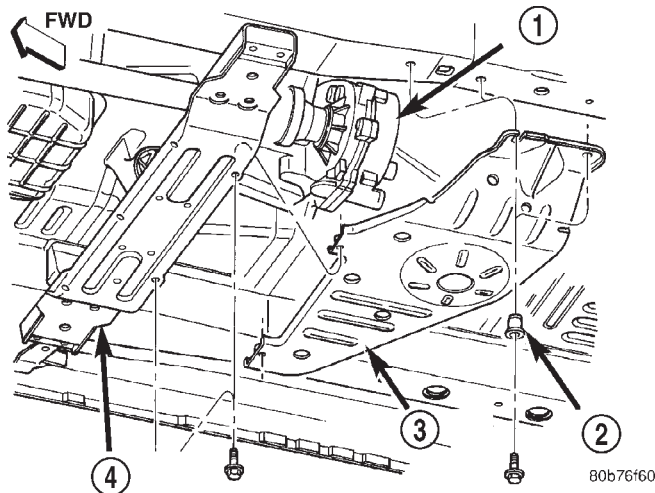

**Fig. 3 Transfer Case Skid Plate**

- 1 - TRANSFER CASE
- 2 - NUTSERT
- 3 - SKID PLATE
- 4 - CROSSMEMBER

## INSTALLATION

- (1) Install nutserts, if removed.
- (2) Position and support skid plate at the frame sill and transmission support crossmember.
- (3) Attach skid plate to frame sill and crossmember with the bolts. Tighten bolts to 34 N·m (25 ft. lbs) torque.

## FUEL TANK SKID PLATE

The fuel tank skid plate is integrated with the fuel tank. Refer to Fuel Tank for service procedures

## REAR TOW HOOK

## REMOVAL

- (1) Remove rear tow hook to frame brace.
- (2) Remove bolts attaching the tow hook bracket to frame (Fig. 4).
- (3) Separate tow hook bracket from frame.

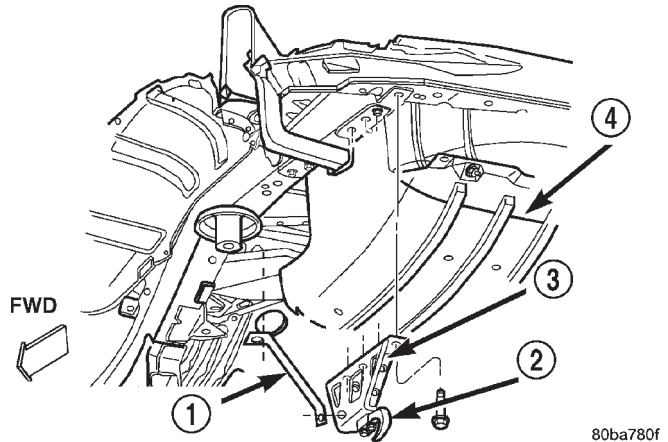

**Fig. 4 Rear Tow Hook**

- 1 - TOW HOOK BRACE
- 2 - TOW HOOK
- 3 - BRACKET
- 4 - FUEL TANK

## INSTALLATION

- (1) position tow hook bracket on frame.
- (2) Install bolts attaching tow hook bracket to frame. Tighten bolts to 68 N·m (50 ft. lbs.) torque.
- (3) Install rear tow hook to frame brace.

## TRAILER HITCH

## REMOVAL

- (1) Raise and support vehicle.
- (2) Remove rear fascia.
- (3) Remove screws attaching trailer harness plug to trailer hitch.
- (4) Disconnect harness connector from harness plug.
- (5) Position support stands under trailer hitch.



## REMOVAL AND INSTALLATION (Continued)

- (6) Remove bolts attaching trailer hitch to frame rails (Fig. 5).
- (7) Separate trailer hitch from vehicle.

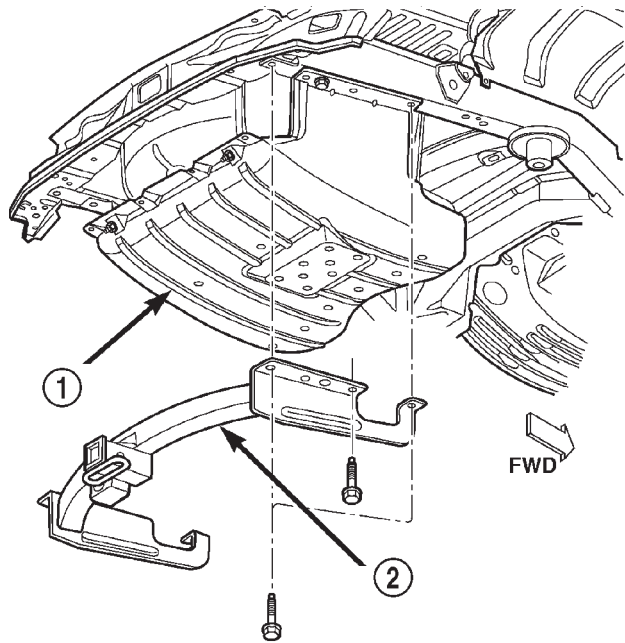

**Fig. 5 Trailer Hitch**

- 1 - FUEL TANK
- 2 - TRAILER HITCH

**INSTALLATION**

- (1) Position trailer hitch on support stands.
- (2) Position trailer hitch on vehicle.
- (3) Install bolts attaching trailer hitch to frame rails. Tighten bolts to 68 N·m (50 lbs.) torque.
- (4) Connect harness connector to harness plug.
- (5) Position harness plug in trailer hitch and install screws.
- (6) Install rear fascia.
- (7) Remove supports and lower vehicle.

**SPECIFICATIONS****FRAME DIMENSIONS**

SPECIFICATIONS (Continued)

SIDE VIEW

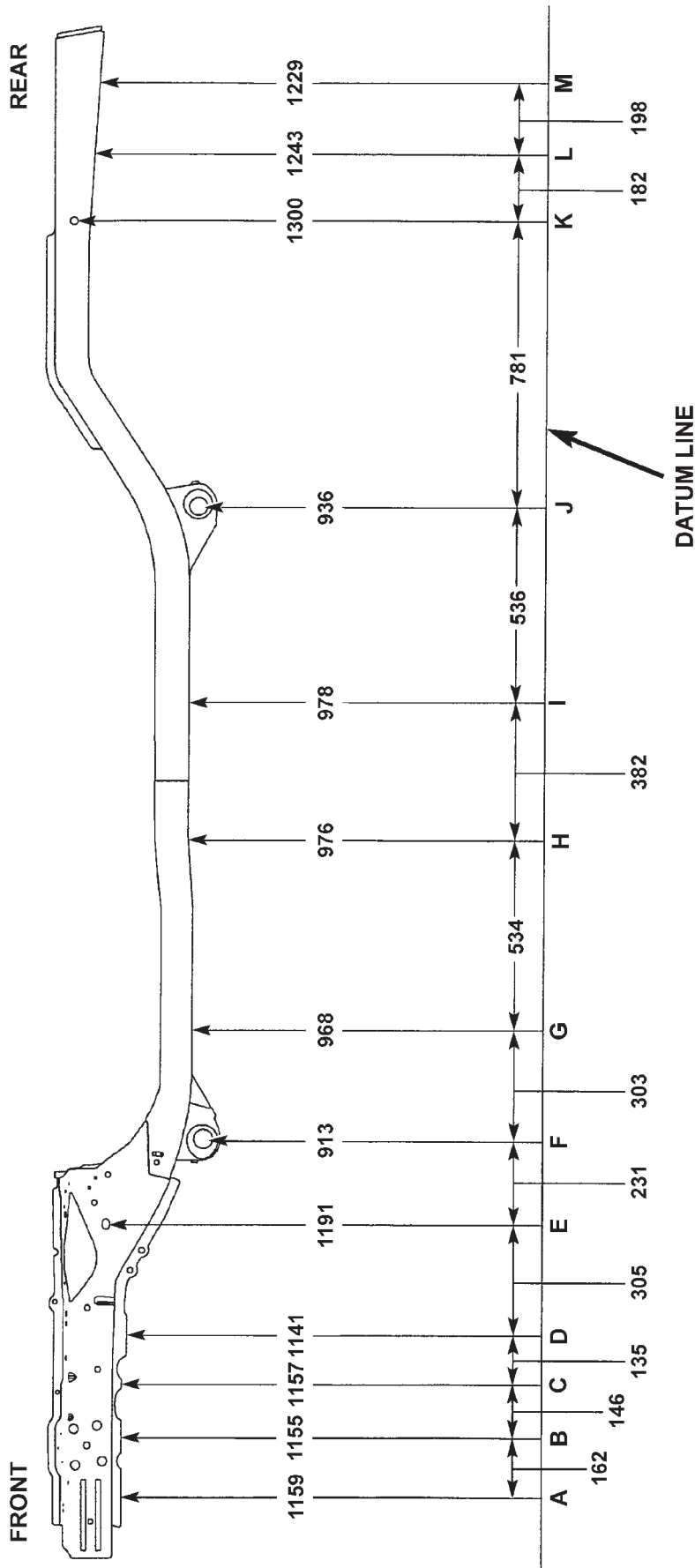

SIDE VIEW

DATUM HEIGHT DIMENSIONS ARE PERPENDICULAR TO DATUM PLANE.  
DATUM LENGTH DIMENSIONS ARE PARALLEL TO CENTERLINE OF VEHICLE,  
AND ARE MEASURED CENTER-TO-CENTER.

ALL MEASUREMENTS ARE IN MILLIMETERS

80b6f6ba



SPECIFICATIONS (Continued)

BOTTOM VIEW

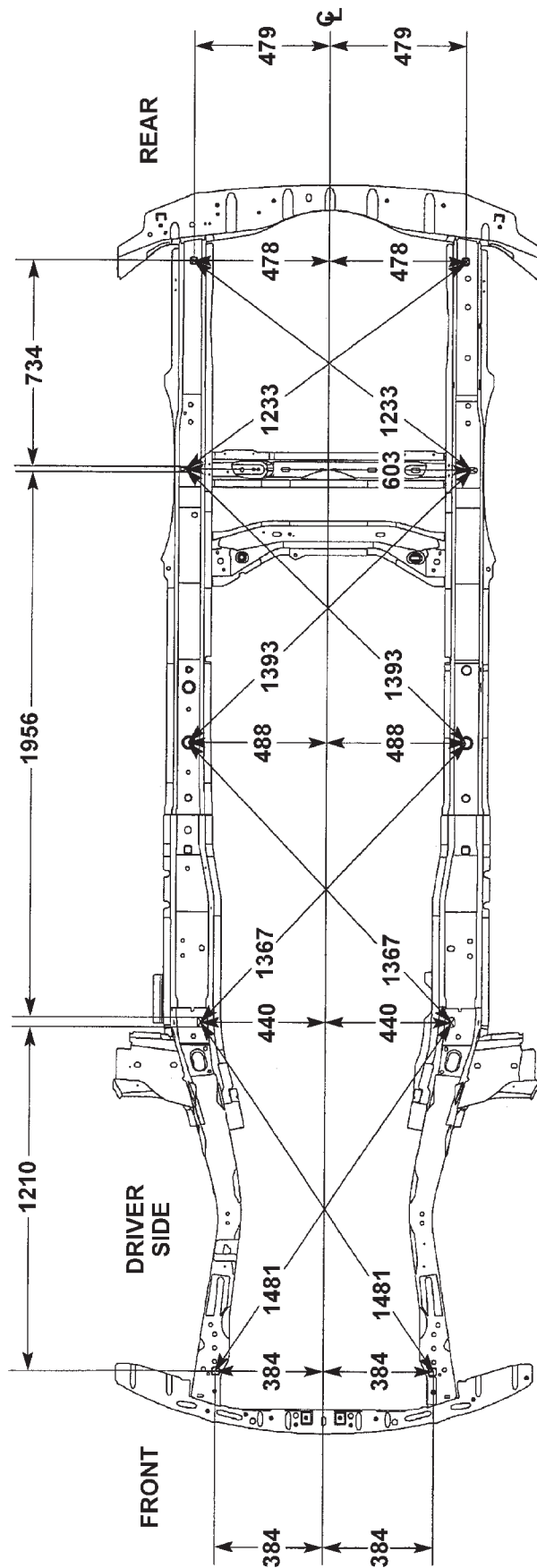

BOTTOM VIEW

BOTTOM VIEW POINT-TO-POINT DIMENSIONS ARE TAKEN WITH TRAM BAR POINTERS SET AT EQUAL LENGTHS. BOLTS AND STUDS ARE MEASURED TO CENTER. HOLES ARE MEASURED TO CLOSEST EDGE.

ALL MEASUREMENTS ARE IN MILLIMETERS

80b6f6bb

## SPECIFICATIONS (Continued)

## TORQUE SPECIFICATIONS

<b>DESCRIPTION</b>	<b>TORQUE</b>
Front Tow Hook Bolt . . . . .	54 N·m (40 ft. lbs.)
Front Skid Plate Bolt . . . . .	54 N·m (40 ft. lbs.)
Rear Tow Hook Bolt . . . . .	68 N·m (50 ft. lbs.)
Trailer Hitch Bolts . . . . .	68 N·m (50 ft. lbs.)
Transfer Case Skid Plate Bolts . .	34 N·m (25ft. lbs.)